

V10 SHORTENING CLUTCH

This V10, Italian made shortening clutch shortens chain without losing any of its working load limit. Quenched and tempered before proof testing, it proves how safe it really is. A quality product that comes in a variety of sizes with a Working Load Limit up to 22,600 lbs. It meets or exceeds OSHA, Government, NACM, and ASTM specs and comes in a blue powder coat finish.



FEATURES

- Grade 100
- Made from premium fine grain alloy steel
- Made in Italy
- Quenched and tempered before proof testing
- Blue powder coat finish
- Meets or exceeds OSHA, Government, NACM, and ASTM specs
- Chain doesn't lose its working load limit
- Easy connection to chain



PRODUCT SPECIFICATIONS

Click on a product to view details or select multiple products to compare



Product	Manufacturer Part No.	Trade Size (Inches)	Trade Size mm	Dim A	Dim B	Dim C	Dim D	Dim E	Dim F	Dim G	Dim P x L	Lbs. Per Ea.	Working Load Limit (Lbs.)
<input type="checkbox"/> 8948100	CXX06	7/32	6	0.315	0.315	0.394	0.315	0.748	1.772	0.906	0.30 x 0.69	0.46	3100
<input type="checkbox"/> 8948200	CXX07	9/32	7	0.374	0.374	0.394	0.374	0.925	2.205	1.142	0.35 x 0.89	1.06	4300
<input type="checkbox"/> 8948300	CXX08	5/16	8	0.374	0.374	0.394	0.374	0.925	2.205	1.142	0.39 x 0.89	1.06	5700
<input type="checkbox"/> 8948400	CXX10	3/8	10	0.472	0.472	0.571	0.472	1.280	3.071	1.417	0.51 x 1.24	2.47	8800
<input type="checkbox"/> 8948600	CXX13	1/2	13	0.610	0.610	0.709	0.610	1.732	3.543	1.378	0.63 x 1.65	4.04	15000
<input type="checkbox"/> 8948700	CXX16	5/8	16	0.748	0.827	0.827	0.748	1.969	4.173	1.496	0.83 x 2.03	6.24	22600

Compare

DIAGRAM DRAWINGS

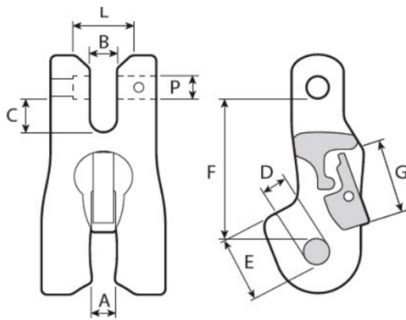

DESIGN

GRADE

- 100

FINISH

- Blue Powder Coat Finish

STANDARDS

- Meets or exceeds OSHA, Government, NACM, and ASTM specs

HEAT TREATMENT

- Quenched and tempered before proof testing

ORIGIN

- Made in Italy

APPLICATION

- Overhead Lifting

MATERIAL

- Premium Fine Grain Alloy Steel