

# V10 CLEVIS SHORTENING GRAB HOOK WITH RETAINER SERIES

For chain tightening, tie downs, or lifting applications, the V10 Grab Hook With Retainer has got you covered. The cradle of this hook will support the entire chain link -- keeping 100% of the working load limit. As an added feature, the retainer prevents the chain from slipping off the grab hook. The clevis connection provides a quick and secure connection, ideal for fast-moving jobs in many different environments: construction, automotive, aircraft, farming -- you name it, the V10 Grab Hook With Retainer will definitely help. It meets or exceeds OSHA, Government, NACM, and ASTM specs and comes in a blue powder coat finish.



## FEATURES

- Grade 100
- Premium fine grain alloy steel
- Made in Italy
- Quenched and tempered before proof testing
- Blue powder coat finish
- Meets or exceeds OSHA, Government, NACM, and ASTM specs
- No reduction in working load limit
- Presence of a chain shape groove for optimal chain position

# V10 CLEVIS SHORTENING GRAB HOOK WITH RETAINER SERIES

---

## GRADE

- 100

## FINISH

- Blue Powder Coat Finish

## STANDARDS

- Meets or exceeds OSHA, Government, NACM, and ASTM specs

## ATTACHMENT

- Clevis

## HEAT TREATMENT

- Quenched and tempered before proof testing

## ORIGIN

- Made in Italy

## HOOK TYPE

- Grab Hook

## APPLICATION

- Overhead Lifting

## MATERIAL

- Premium Fine Grain Alloy Steel



[WWW.KITO.CA](http://www.kito.ca) | 1.888.322.KITO (5486)

All specifications, dimensions and drawings are available at [www.kito.ca](http://www.kito.ca), or call our Customer Service staff for friendly and expert advice on models and options.

2

V10 ALLOY CHAIN  
ACCESSORIES

# V10 CLEVIS SHORTENING GRAB HOOK WITH RETAINER SERIES

---

## DIAGRAM DRAWINGS

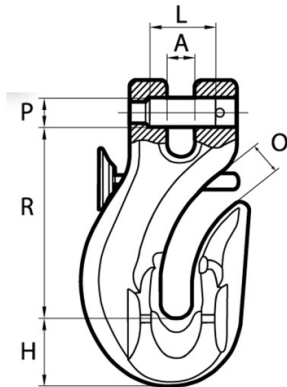

# V10 CLEVIS SHORTENING GRAB HOOK WITH RETAINER SERIES

## PRODUCTS SPECIFICATIONS

Product	Manufacturer Part No.	Chain Size Inches	Chain Size mm	Dim A	Dim H	Dim O	Dim P x L	Dim R	Lbs. Per Ea.	Working Load Limit (Lbs.)
8929100		7/32	6	0.276	0.689	0.276	0.29 X 0.65	2.008	0.55	2,700
8929200	---	9/32 - 5/16	7 - 8	0.354	0.925	0.374	0.38 X 0.91	2.598	1.32	5700
8929400	---	3/8	10	0.453	1.142	0.472	0.49 X 1.16	3.228	2.51	8800
8929620	---	1/2	13	0.571	1.535	0.650	0.63 X 1.46	4.170	4.63	15000
8929720	---	5/8	16	0.709	1.811	0.866	0.79 X 2.05	5.118	8.38	22600



WWW.KITO.CA | 1.888.322.KITO (5486)

All specifications, dimensions and drawings are available at [www.kito.ca](http://www.kito.ca), or call our Customer Service staff for friendly and expert advice on models and options.

V10 ALLOY CHAIN  
ACCESSORIES

# V10 CLEVIS SHORTENING GRAB HOOK WITH RETAINER SERIES

---

## RELATED PRODUCTS