

V10 EYE GRAB HOOK WITH CLEVIS ATTACHMENT SERIES

For chain tightening, tie downs, or lifting applications, the V10 Eye Grab Hook With Clevis Attachment has got you covered. Whether you need the clevis or eye fit, the cradle of this hook will still support the entire chain link - keeping 100% of the working load limit. The eye connection provides a long-term and secure connection, ideal for on-going jobs in many different environments: construction, automotive, aircraft, farming -- you name it, this hook can probably help. It doesn't stop there... this Eye Grab Hook is also equipped with a clevis attachment, providing a secure attachment to chain and slings. Quenched and tempered before proof testing, this hook meets or exceeds OSHA, Government, NACM, and ASTM specs. It is available in a blue powder coat finish.



FEATURES

- Grade 100
- Premium fine grain alloy steel
- Made in Italy
- Quenched and tempered before proof testing
- Blue powder coat finish
- Meets or exceeds OSHA, Government, NACM, and ASTM specs
- No reduction in working load limit
- Presence of a chain shape groove for optimal chain position

KITO**WWW.KITO.CA | 1.888.322.KITO (5486)**All specifications, dimensions and drawings are available at www.kito.ca, or call our Customer Service staff for friendly and expert advice on models and options.

1

V10 ALLOY CHAIN
ACCESSORIES

V10 EYE GRAB HOOK WITH CLEVIS ATTACHMENT SERIES

GRADE

- 100

FINISH

- Blue Powder Coat Finish

STANDARDS

- Meets or exceeds OSHA, Government, NACM, and ASTM specs

ATTACHMENT

- Eye and Clevis

HEAT TREATMENT

- Quenched and tempered before proof testing

ORIGIN

- Made in Italy

HOOK TYPE

- Grab Hook

APPLICATION

- Overhead Lifting

MATERIAL

- Premium Fine Grain Alloy Steel



[WWW.KITO.CA](http://www.kito.ca) | 1.888.322.KITO (5486)

All specifications, dimensions and drawings are available at www.kito.ca, or call our Customer Service staff for friendly and expert advice on models and options.

2

V10 ALLOY CHAIN
ACCESSORIES

V10 EYE GRAB HOOK WITH CLEVIS ATTACHMENT SERIES

DIAGRAM DRAWINGS

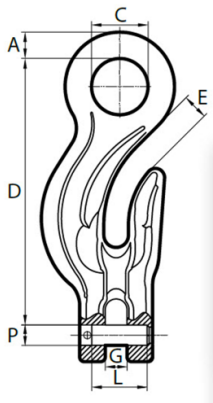

V10 EYE GRAB HOOK WITH CLEVIS ATTACHMENT SERIES

PRODUCTS SPECIFICATIONS

| Product | Manufacturer Part No. | Chain Size Inches | Chain Size mm | Dim A | Dim C | Dim D | Dim E | Dim G | Dim P x L | Lbs. Per Ea. | Working Load Limit (Lbs.) |
|---------|-----------------------|-------------------|---------------|-------|-------|-------|-------|-------|-------------|--------------|---------------------------|
| 8920100 | --- | 7/32 | 6 | 0.406 | 0.709 | 3.484 | 0.315 | 0.256 | 0.29 x 0.65 | 0.60 | 2700 |
| 8920200 | --- | 9/32 - 5/16 | 7 - 8 | 0.531 | 0.945 | 4.606 | 0.354 | 0.358 | 0.38 x 0.91 | 1.35 | 5700 |
| 8920400 | --- | 3/8 | 10 | 0.630 | 1.220 | 5.827 | 0.531 | 0.453 | 0.49 x 1.16 | 2.69 | 8800 |
| 8920600 | --- | 1/2 | 13 | 0.787 | 1.457 | 7.283 | 0.610 | 0.571 | 0.63 x 1.46 | 5.62 | 15000 |
| 8920700 | --- | 5/8 | 16 | 1.043 | 1.890 | 9.134 | 0.787 | 0.689 | 0.79 x 2.05 | 10.80 | 22600 |