

KUPLEX® CLEVIS FOUNDRY HOOKS

The Kuplex® Clevis Foundry Hook is made of premium quality, alloy steel and offers a wide throat opening to accommodate a variety of attachments. The clevis end permits quick and secure attachments to slings and chains. This Canadian made foundry hook is approved for overhead lifting, and meets the latest guidelines of the NACM and ASTM A391/A391M (Grade 80) or ASTM A973/A973M (Grade 100). Choose a self-colored or a red powder coat finish.



KUPLEX® CLEVIS FOUNDRY HOOKS

GRADE

- 80 and 100

FINISH

- Powder coated red

STANDARDS

- Meet the latest guidelines of the NACM and ASTM A391/A391M (Grade 80) or ASTM A973/A973M (Grade 100)

ATTACHMENT

- Kuplex Clevis

HEAT TREATMENT

- Quenched and tempered before proof testing

ORIGIN

- Made in Canada

HOOK TYPE

- Foundry Hook

APPLICATION

- Overhead Lifting

MATERIAL

- Premium quality, high strength alloy steel

KUPLEX® CLEVIS FOUNDRIY HOOKS

DIAGRAM DRAWINGS

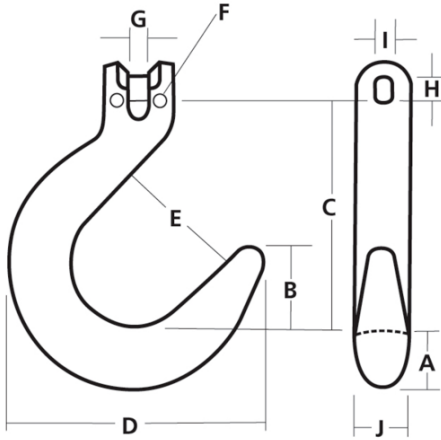

KUPLEX® CLEVIS FOUNDRY HOOKS

PRODUCTS SPECIFICATIONS

| Product | ID # | Chain Size Inches | Chain Size mm | Grade | Dim A (in.) | Dim B (in.) | Dim C (in.) | Dim D (in.) | Dim E (in.) | Dim F (in.) | Dim G (in.) | Dim H (in.) | Dim I (in.) | Dim J (in.) | Lbs. Per Ea. | Working Load Limit (Lbs.) |
|-----------|-------|-------------------|---------------|-------|-------------|-------------|-------------|-------------|-------------|-------------|-------------|-------------|-------------|-------------|--------------|---------------------------|
| 598200502 | K-502 | 3/4 | 20 | 80 | 2.750 | 3.000 | 8.813 | 9.625 | 4.813 | 0.313 | 0.813 | 1.219 | 1.000 | 2.000 | 24.5 | 28300 |
| 598200503 | K-503 | 7/8 | 22 | 80 | 3.000 | 3.375 | 9.938 | 10.688 | 5.375 | 0.375 | 0.938 | 1.281 | 1.063 | 2.250 | 33.1 | 34200 |
| 598250498 | K-498 | 9/32 | 7 | 100 | 1.125 | 1.563 | 4.438 | 4.875 | 2.625 | 0.125 | 0.313 | 0.406 | 0.344 | 0.875 | 2.1 | 4300 |
| 598250499 | K-499 | 3/8 | 10 | 100 | 1.375 | 1.875 | 5.500 | 5.875 | 3.000 | 0.156 | 0.438 | 0.563 | 0.469 | 1.125 | 4.3 | 8800 |
| 598250500 | K-500 | 1/2 | 13 | 100 | 1.500 | 2.250 | 6.625 | 6.875 | 3.875 | 0.188 | 0.563 | 0.750 | 0.656 | 1.500 | 8.2 | 15000 |
| 598250501 | K-501 | 5/8 | 16 | 100 | 2.188 | 2.563 | 7.625 | 8.281 | 4.125 | 0.250 | 0.688 | 0.938 | 0.813 | 1.750 | 14.4 | 22600 |