

# V10™ COUPLING LINKS

---

The V10™ Coupling Link is an essential component of mechanically coupled slings and is primarily used to connect chain sling legs to the master link or fittings. All V10™ fittings are engineered to outperform market standards and are designed to meet or exceed OSHA, Government, NACM, and ASTM specs. All V10™ products are accompanied with a product test certificate.



# V10™ COUPLING LINKS

---

## GRADE

- 100

## FINISH

- Blue Powder Coat Finish

## STANDARDS

- Safety factor 4:1
- Meets or exceeds ASTM A952 & OSHA 910 Standards
- Fatigue Tested at 1.5 times the WLL for 20,000 cycles
- Proof Tested at twice the WLL

## ATTACHMENT

- Link

## HEAT TREATMENT

- Quenched and tempered before proof testing

## ORIGIN

- Made in Italy

## LINK TYPE

- Coupling Link

## APPLICATION

- Overhead Lifting

## MATERIAL

- Premium Fine Grain Alloy Steel

# V10™ COUPLING LINKS

## DIAGRAM DRAWINGS

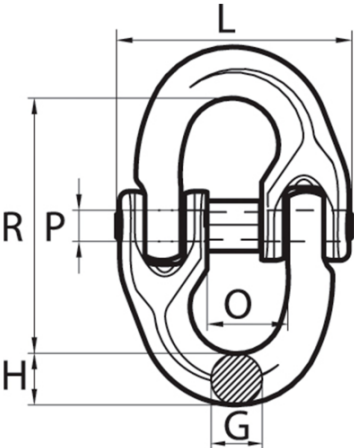

# V10™ COUPLING LINKS

## PRODUCTS SPECIFICATIONS

Product	Manufacturer Part No.	Trade Size (in.)	Trade Size mm	Dim G (in.)	Dim H (in.)	Dim O (in.)	Dim P x L (in.)	Dim R (in.)	Lbs. Per Ea.	Working Load Limit (Lbs.)
8452900	CLX06	7/32	6	0.299	0.307	0.551	0.19 X 1.54	1.732	0.15	2700
8453000	CLX08	5/16	8	0.394	0.453	0.709	0.25 X 2.09	2.421	0.42	5700
8453100	CLX07	9/32	7	0.354	0.3694	0.669	0.24 X 1.85	2.008	0.26	4300
8453210	CLX10	3/8	10	0.496	0.543	0.886	0.32 X 2.48	2.835	0.84	8800
8453300	CLX13	1/2	13	0.657	0.748	1.083	0.39 X 3.11	3.465	1.61	15000
8453400	CLX16	5/8	16	0.827	0.827	1.299	0.55 X 4.17	4.055	3.15	22600
8453510	CLX20	3/4	20	0.925	1.161	1.634	0.63 X 4.96	4.528	5.86	35300
8453610	CLX22	7/8	22	1.063	1.142	1.909	0.63 X 5.75	5.315	8.29	42700