

PEER-LIFT® EYE SLING HOOKS WITH LATCH

Proof tested at twice the Working Load Limit and fatigue tested at 1.5 times the Working Load Limit for 20,000 cycles, the Peer-Lift® Eye Sling Hook with Latch has proven itself. As an additional safety feature, the hook latch helps to prevent the load from slipping off the hook. Most commonly used with choker chain slings, this Grade 80 eye sling hook with latch meets or exceeds ASTM A952 and OSHA 1910 standards.



PEER-LIFT® EYE SLING HOOKS WITH LATCH

GRADE

- 80

FINISH

- Black Enamel

STANDARDS

- Meets or exceeds ASTM A952 and OSHA 1910 standards
- Proof tested at twice the Working Load Limit
- Grade 80
- Fatigue tested at 1.5 times the working load limit for 20,000 cycles

ATTACHMENT

- Eye

HEAT TREATMENT

- Quenched and tempered before proof testing

HOOK TYPE

- Sling Hook with latch
- Full, wide throat (choker hitch)

APPLICATION

- Overhead Lifting

MATERIAL

- Premium Fine Grain Alloy Steel

PEER-LIFT® EYE SLING HOOKS WITH LATCH

DIAGRAM DRAWINGS

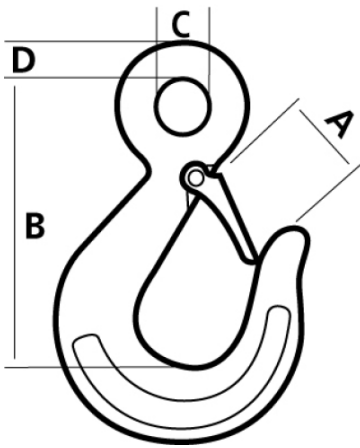

PEER-LIFT® EYE SLING HOOKS WITH LATCH

PRODUCTS SPECIFICATIONS

Product	Chain Size Inches	Chain Size mm	Dim A (in.)	Dim B (in.)	Dim C (in.)	Dim D (in.)	Lbs. Per Ea.	Working Load Limit (Lbs.)
8517280	9/32	7	1.390	4.560	1.120	0.480	1.5	3500
8517480	3/8	10	1.840	5.680	1.410	0.630	3.0	7100
8517680	1/2	13	2.200	7.260	1.750	0.730	4.2	12000
8517780	5/8	16	2.500	8.680	2.120	1.000	10.4	18100