

# PEER-LIFT® MECHANICAL COUPLING LINKS

---

Peer-Lift® Mechanical Coupling Links are an essential component of mechanically coupled slings. Used to assemble chain legs to the master link and/or attach eye type fittings. Tested at twice the Working Load Limit, this Grade 80 coupling link will provide a safe and reliable sling assembly. Peer-Lift® Mechanical Coupling Link is an industry recognized product that meets or exceeds ASTM A952 and OSHA 1910 standards.



# PEER-LIFT® MECHANICAL COUPLING LINKS

---

## GRADE

- 80

## FINISH

- Black Enamel

## STANDARDS

- Meets or exceeds ASTM A952 and OSHA 1910 standards

## HEAT TREATMENT

- Quenched and tempered before proof testing
- Proof tested at twice the Working Load Limit

## LINK TYPE

- Mechanical Coupling Link
- For connecting hooks, chain, and other lifting components

## APPLICATION

- Overhead Lifting

## MATERIAL

- Premium Fine Grain Alloy Steel

# PEER-LIFT® MECHANICAL COUPLING LINKS

---

## DIAGRAM DRAWINGS

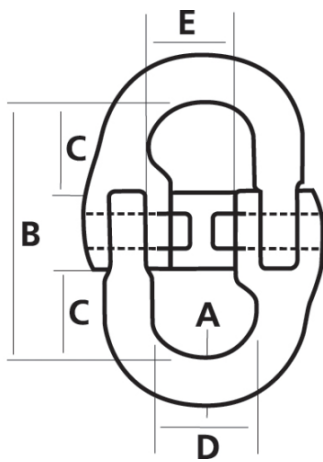

# PEER-LIFT® MECHANICAL COUPLING LINKS

## PRODUCTS SPECIFICATIONS

Product	Chain Size Inches	Chain Size mm	Dim A (in.)	Dim B (in.)	Dim C (in.)	Dim D (in.)	Dim E (in.)	Lbs. Per Ea.	Working Load Limit (Lbs.)
8553180	9/32	7	0.344	2.109	0.844	0.828	0.828	0.3	3500
8553280	3/8	10	0.469	2.625	1.047	1.016	0.984	0.8	7100
8553380	1/2	13	0.625	3.438	1.391	1.297	1.219	1.7	12000
8553480	5/8	16	0.797	4.000	1.656	1.625	1.531	3.0	18100