

# TRANSPORT (T80) CLEVIS GRAB HOOK - DOMESTIC

Need to bind a heavy load? Look no further - this Transport Grade 80 Clevis Grab Hook is perfect for load binding applications on a transport chain. Make your attachment to chain quick and easy with the clevis pin on the grab hook. This domestic hook is made of forged alloy steel and is quenched and tempered before proof testing. It meets DOT/CVSA/CCMTA requirements and is self-colored. NOT for overhead lifting.



# TRANSPORT (T80) CLEVIS GRAB HOOK - DOMESTIC

---

## GRADE

- 80

## FINISH

- Self-colored

## STANDARDS

- Meets DOT/CVSA/CCMTA requirements

## ATTACHMENT

- Clevis

## HEAT TREATMENT

- Quenched and tempered before proof testing

## ORIGIN

- Made in USA

## HOOK TYPE

- Grab Hook

## APPLICATION

- Designed for use with transport chain

## MATERIAL

- Forged Alloy Steel

# TRANSPORT (T80) CLEVIS GRAB HOOK - DOMESTIC

## DIAGRAM DRAWINGS

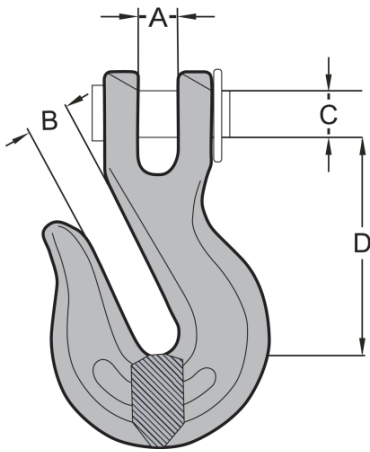

# TRANSPORT (T80) CLEVIS GRAB HOOK - DOMESTIC

## PRODUCTS SPECIFICATIONS

Product	Chain Size Inches	Finish	Dim A (in.)	Dim B (in.)	Dim C (in.)	Dim D (in.)	Quantity Per Pkg.	Lbs. Per Ea.	Working Load Limit (Lbs.)	Working Load Limit (kg)
8024215	1/4	Self Colored	0.31	0.38	0.33	1.88	10	0.42	3500	1588
8024315	5/16	Self Colored	0.38	0.44	0.39	2.38	10	0.72	4500	2041
8024415	3/8	Self Colored	0.45	0.5	0.5	2.63	10	1.14	7100	3221
8024615	1/2	Self Colored	0.59	0.66	0.59	3.31	10	2.32	12000	5443
8024815	5/8	Self Colored	0.75	0.78	0.75	3.94	5	4.08	18100	8210