

316 STAINLESS STEEL OBLONG MASTER LINKS

Welded, electropolished, and proof tested, the Stainless Steel Oblong Master Link is the best option for corrosive environments. With the addition of molybdenum, the 316 Stainless Steel has greater corrosion resistance, improved resistance to pitting from chloride ion solutions, and an increased strength at elevated temperatures. This master link is versatile for rigging applications, including overhead lifting, and is optimally designed for use with crane hooks. USA made, this link is certified to OSHA and ASME standards.



316 STAINLESS STEEL OBLONG MASTER LINKS

GRADE

- 50

FINISH

- Welded, Electropolished, and proof tested

STANDARDS

- Certified to OSHA and ASME standards

ORIGIN

- Made in USA

LINK TYPE

- Master Link

APPLICATION

- Custom Lifting

MATERIAL

- 316 Stainless Steel

316 STAINLESS STEEL OBLONG MASTER LINKS

DIAGRAM DRAWINGS

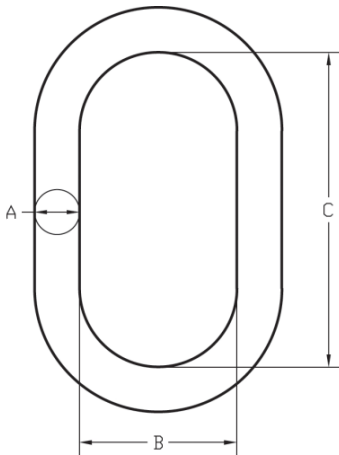

316 STAINLESS STEEL OBLONG MASTER LINKS

PRODUCTS SPECIFICATIONS

Product	Trade Size (in.)	Trade Size mm	Dim A (in.)	Dim B (in.)	Dim C (in.)	Lbs. Per Ea.	Working Load Limit (Lbs.)
OMS038	3/8	10	0.380	2.000	4.000	0.42	750
OMS050	1/2	13	0.500	2.500	5.000	0.94	2150
OMS063	5/8	16	0.630	2.750	5.500	1.63	2850
OMS075	3/4	20	0.750	3.000	6.000	2.50	4600
OMS100	1	26	1.000	3.500	7.000	5.40	7800
OMS125	1-1/4	32	1.250	4.000	8.000	8.75	11800
OMS150	1-1/2	38	1.500	5.250	10.500	17.00	18600