

# 316 STAINLESS STEEL SWIVEL HOOKS

Grade 50 and USA made, the 316 Stainless Steel Swivel Hook is the best option for corrosive environments. With the addition of molybdenum, the 316 Stainless Steel has greater corrosion resistance, improved resistance to pitting from chloride ion solutions, and an increased strength at elevated temperatures. Plus, with the electropolishing anti-corrosion treatment, there's no question this will best suit those corrosive or food-safe environments. The swivel design allows the load to turn or flip without detaching from the hook -- for a precise and efficient lift every time. This hook is welded, electropolished, proof tested, and approved for overhead lifting.



# 316 STAINLESS STEEL SWIVEL HOOKS

---

## GRADE

- 50

## FINISH

- Welded, Electropolished, and proof tested

## STANDARDS

- Certified to OSHA and ASME standards

## ATTACHMENT

- Eye swivel

## ORIGIN

- Made in USA

## HOOK TYPE

- Swivel Hook

## APPLICATION

- Custom Lifting

## MATERIAL

- 316 Stainless Steel

# 316 STAINLESS STEEL SWIVEL HOOKS

## DIAGRAM DRAWINGS

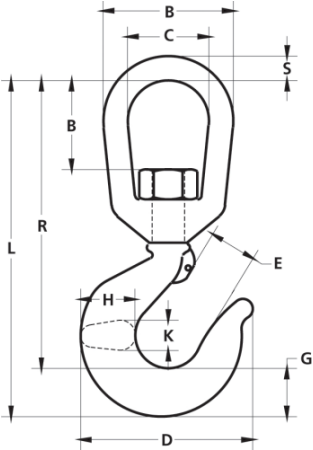

# 316 STAINLESS STEEL SWIVEL HOOKS

## PRODUCTS SPECIFICATIONS

Product	Dim A (in.)	Dim B (in.)	Dim C (in.)	Dim D (in.)	Dim E (in.)	Dim G (in.)	Dim H (in.)	Dim K (in.)	Dim L (in.)	Dim R (in.)	Dim S (in.)	Lbs. Per Ea.	Working Load Limit (Lbs.)
SWS2	2.000	1.000	1.180	3.000	0.930	0.880	0.880	0.560	5.000	4.380	0.380	0.69	1000
SWS3	2.500	1.380	1.380	3.190	1.060	0.880	0.970	0.630	5.500	5.250	0.500	1.40	1500
SWS4	2.500	1.380	1.380	3.560	1.130	1.060	1.120	0.720	6.250	5.630	0.500	1.60	2000
SWS5	3.000	1.630	1.690	3.880	1.250	1.200	1.310	0.810	6.970	6.500	0.630	1.80	2500