

316 STAINLESS STEEL S-HOOKS

The 316 Stainless Steel S-Hook is best suited for corrosive environments. With the addition of molybdenum, the 316 Stainless Steel has greater corrosion resistance, improved resistance to pitting from chloride ion solutions, and an increased strength at elevated temperatures. Plus, with the electropolishing anti-corrosion treatment, there's no question this hook is optimal for those corrosive or food-safe environments. This S-Hook is welded, electropolished, and proof tested, making it a safe and reliable hook. It is certified to OSHA and ASME standards and made in the USA.



316 STAINLESS STEEL S-HOOKS

GRADE

- 50

FINISH

- Welded, Electropolished, and proof tested

STANDARDS

- Certified to OSHA and ASME standards

ORIGIN

- Made in USA

HOOK TYPE

- S-Hook

APPLICATION

- Custom Lifting

MATERIAL

- 316 Stainless Steel

316 STAINLESS STEEL S-HOOKS

DIAGRAM DRAWINGS

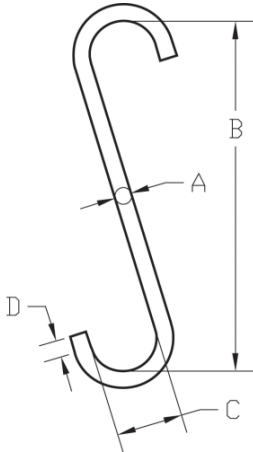

316 STAINLESS STEEL S-HOOKS

PRODUCTS SPECIFICATIONS

Product	Trade Size (in.)	Dim A (in.)	Dim B (in.)	Dim C (in.)	Dim D (in.)	Lbs. Per Ea.	Working Load Limit (Lbs.)
SHS025	1/4	0.250	2.750	0.750	0.380	0.07	75
SHS038	3/8	0.380	4.130	1.130	0.560	0.33	165
SHS050	1/2	0.500	5.500	1.500	0.750	0.59	325
SHS063	5/8	0.630	7.000	1.880	0.940	1.240	500
SHS075	3/4	0.750	8.250	2.250	1.130	2.31	660
SHS088	7/8	0.880	9.630	2.630	1.310	3.05	900
SHS100	1	1.000	11.000	3.000	1.500	4.45	1060